

DETALHE 1  
1/15

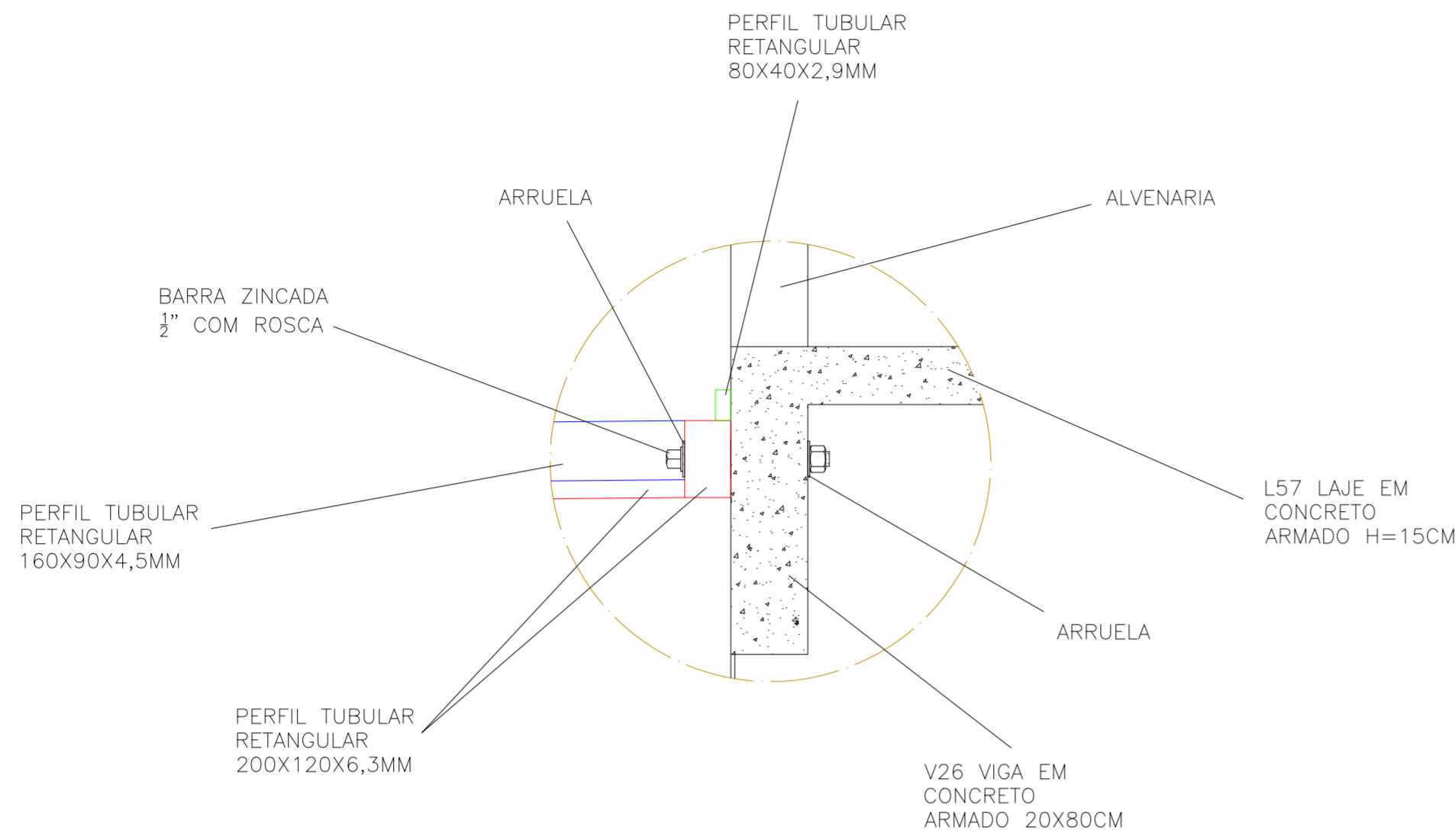

DETALHE 2  
1/15

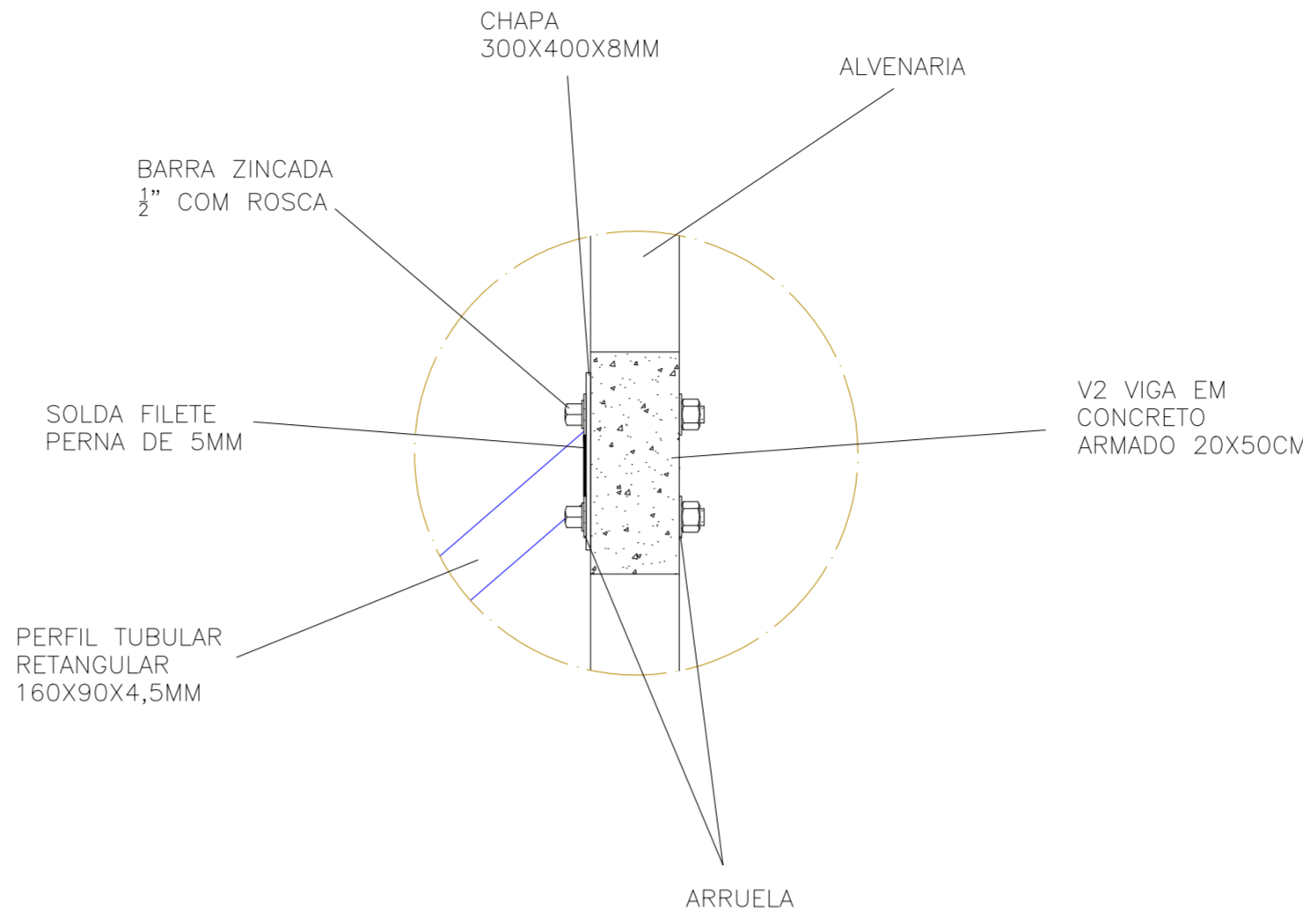

DETALHE 3  
1/15

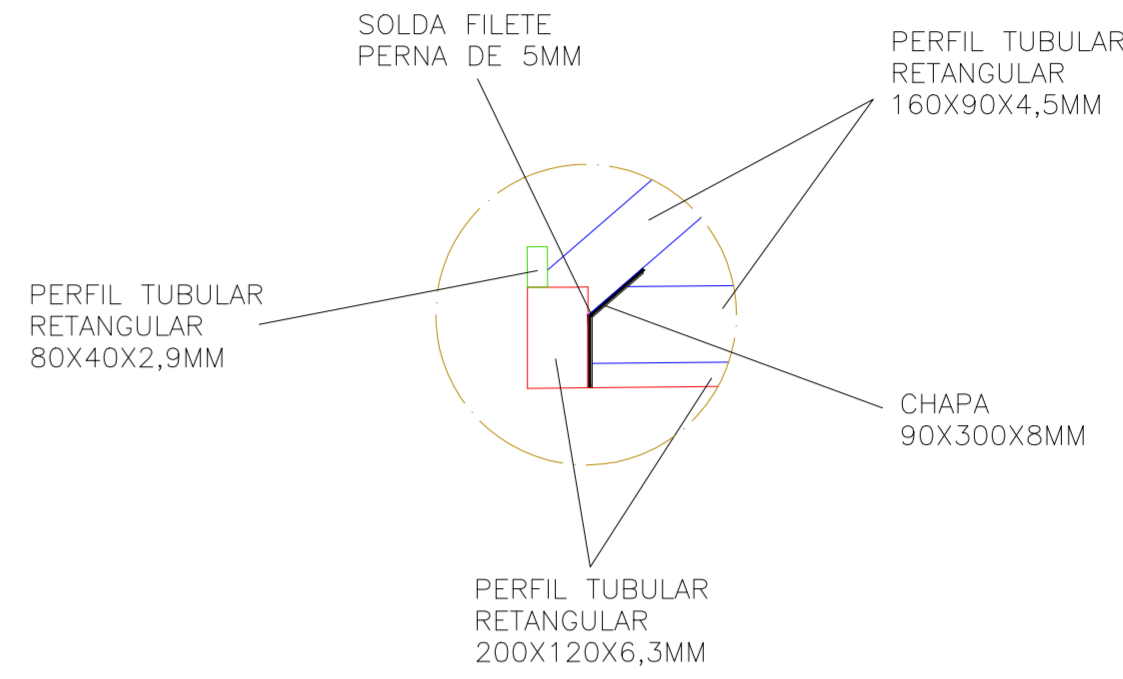

PLANTA BAIXA  
1/40

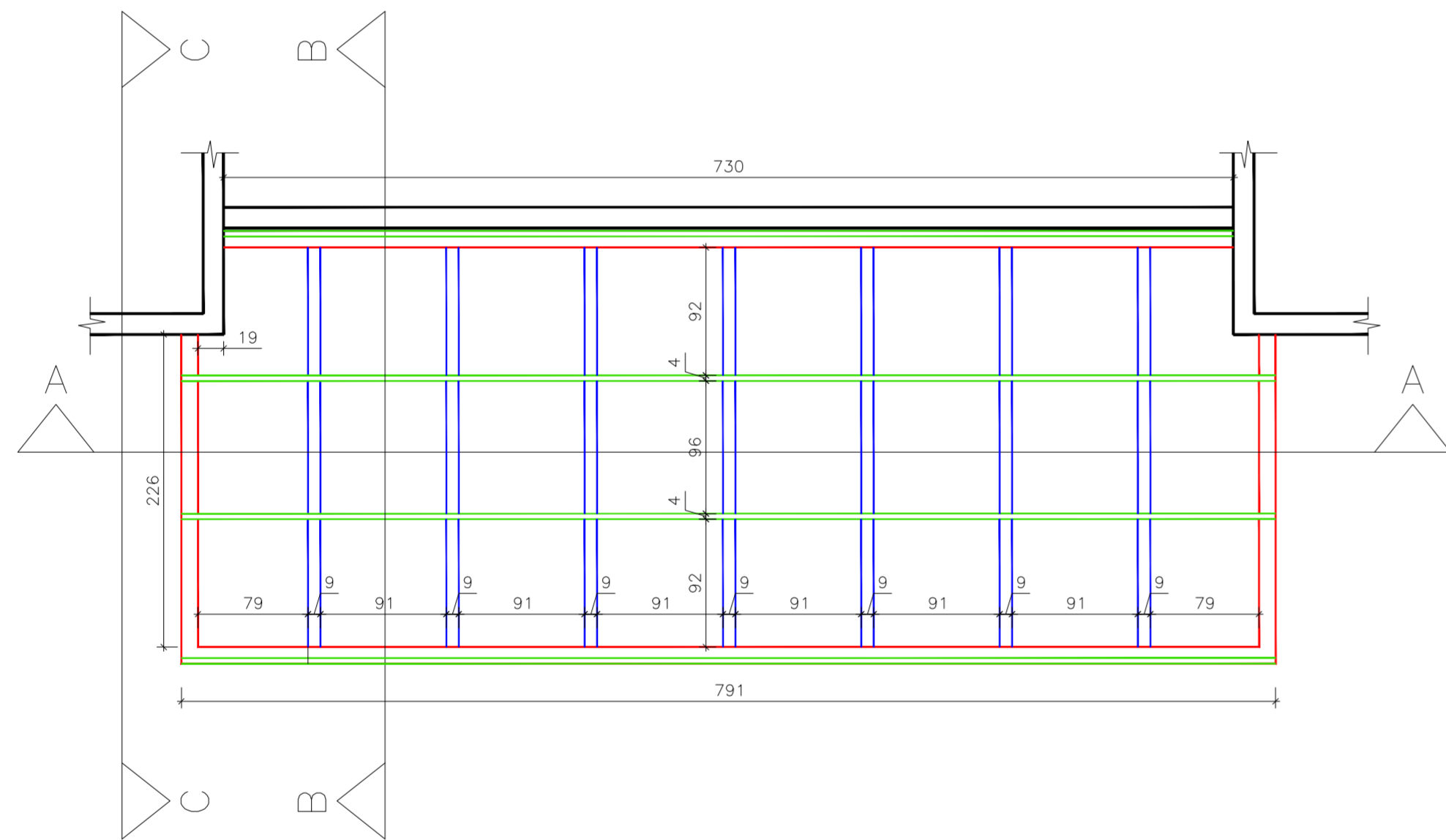

CORTE C-C  
1/40

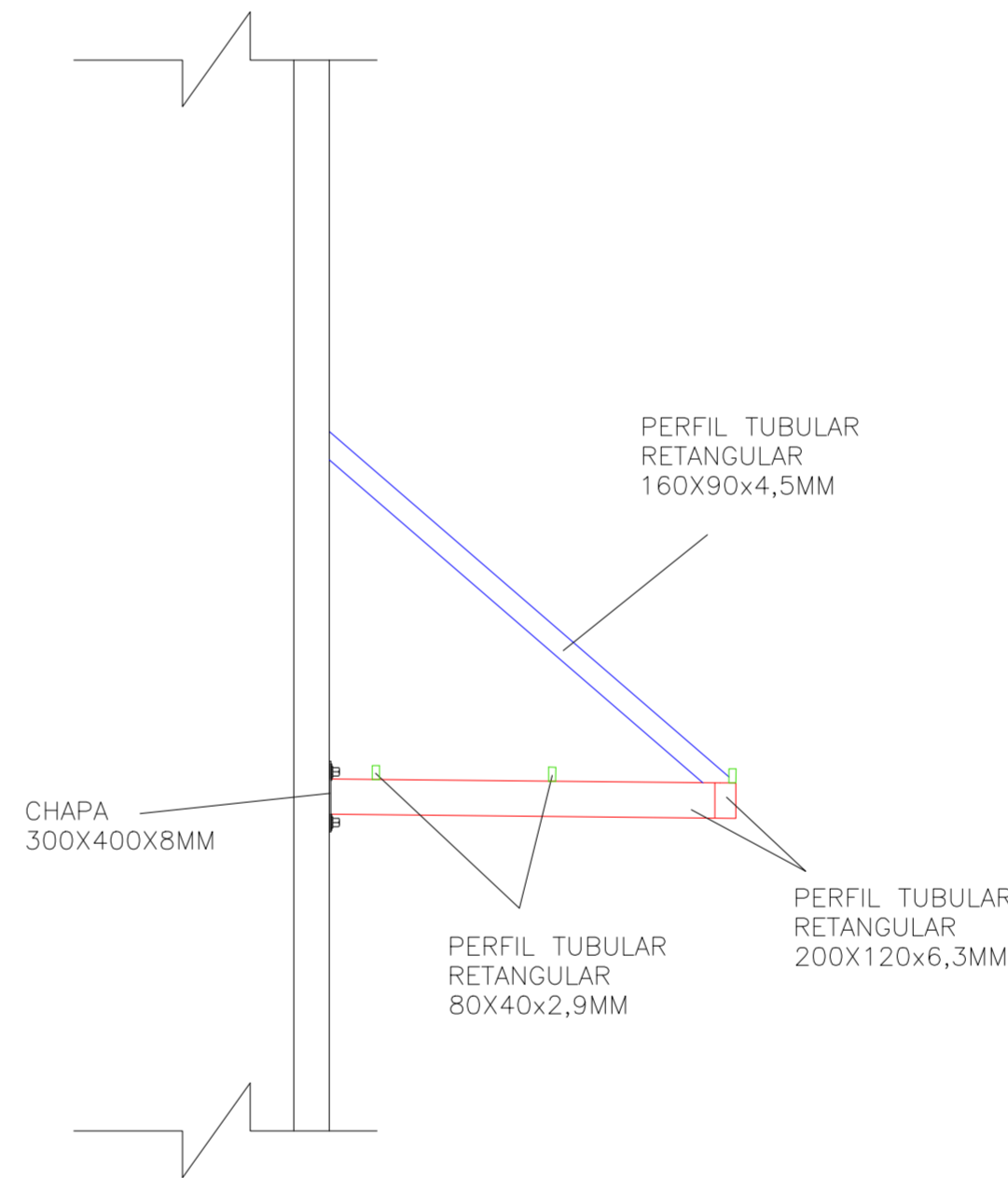

CORTE A-A  
1/40

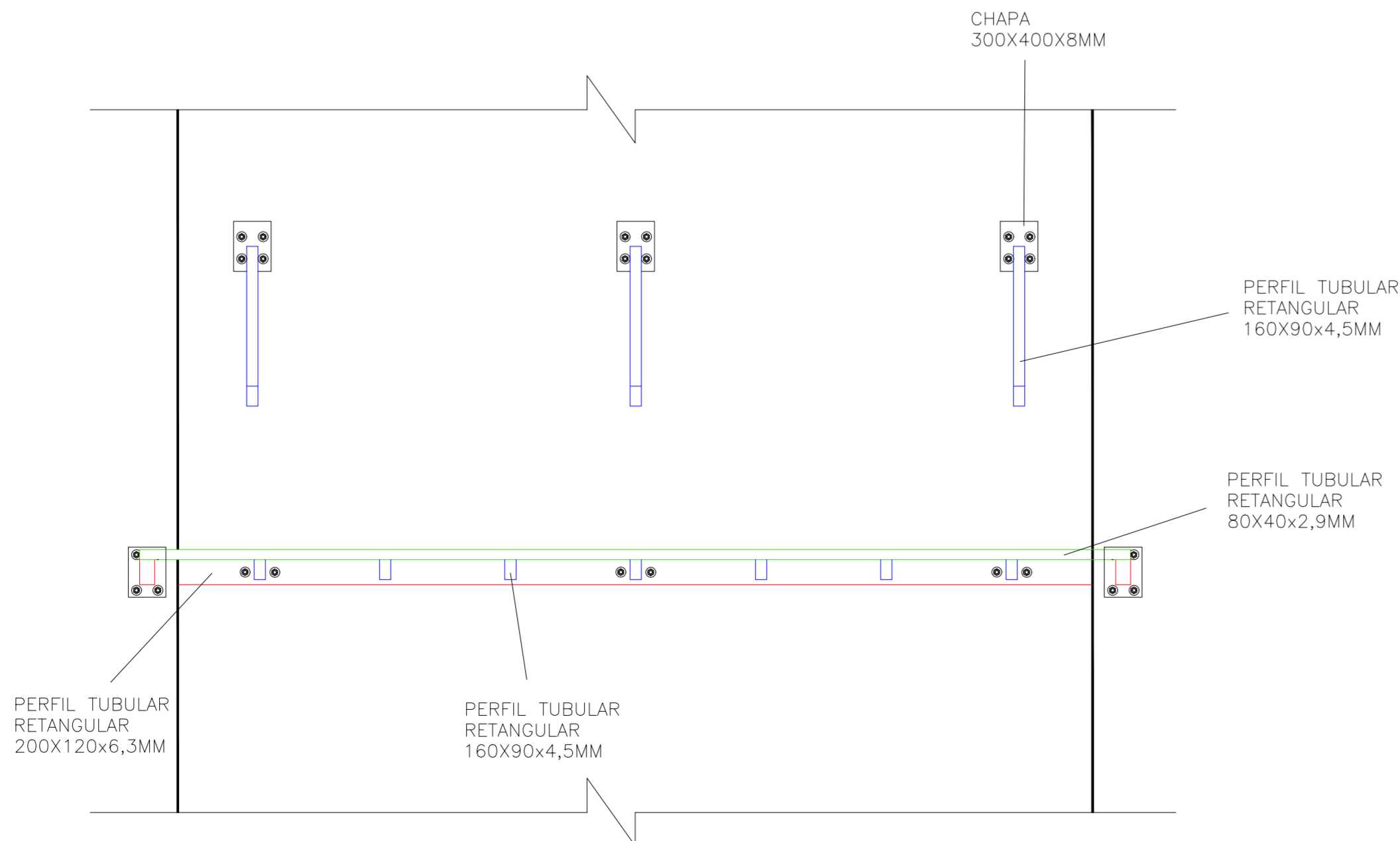

CORTE B-B  
1/40

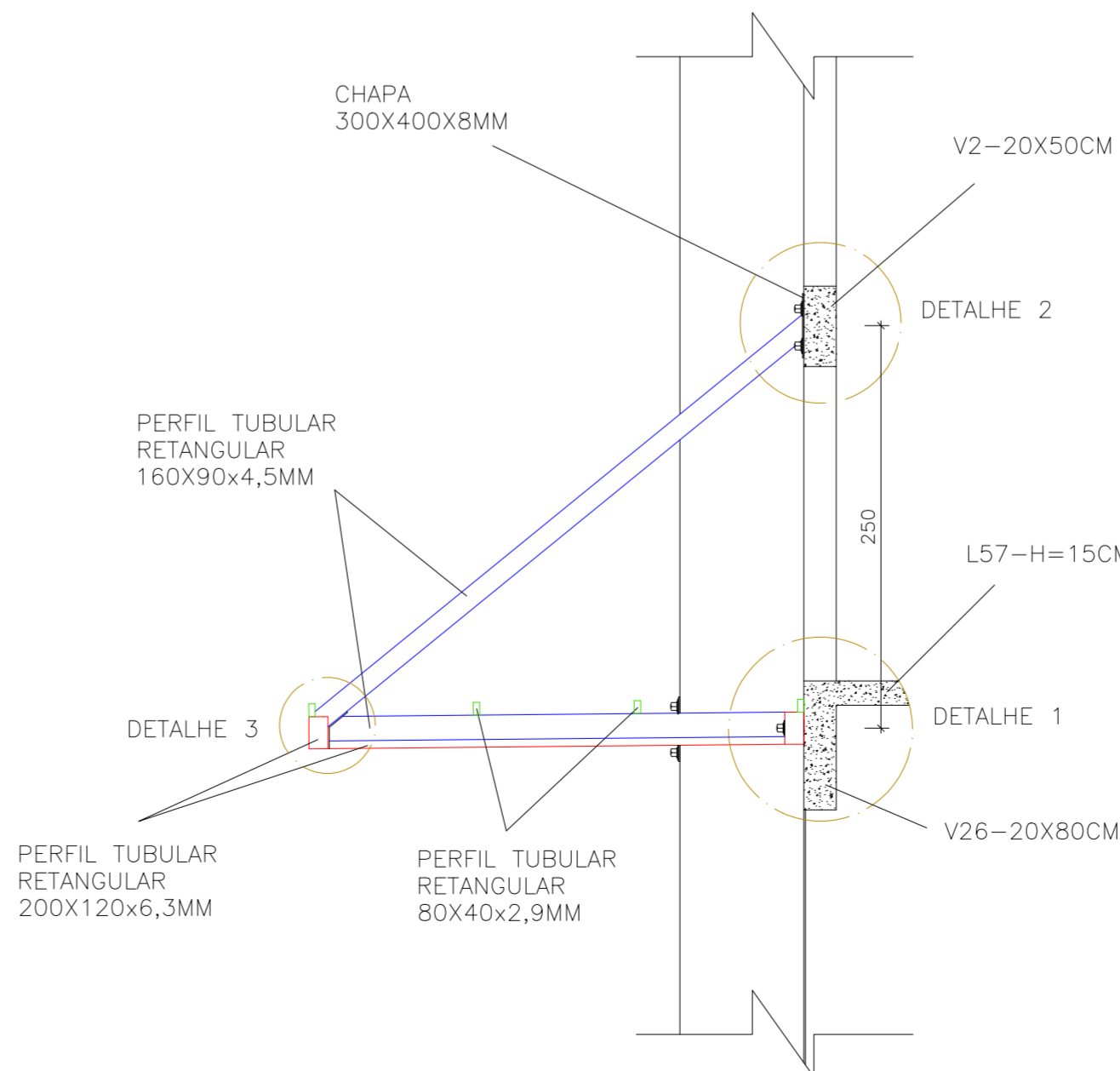

NOTA: TODAS AS LIGAÇÕES SÃO  
FEITAS POR SOLDA FILETE  
CONTINUA EM TODA A LIGAÇÃO.  
PERNA DO FILETE 5 MM

 <b>INSTITUTO FEDERAL FARROUPILHA</b>	<b>PRÓ-REITORIA DE ADMINISTRAÇÃO COORDENAÇÃO DE ENGENHARIA E ARQUITETURA</b> <small>Rua Universitária, 400 - Foz de Azeite - Camobi - CEP 91110-747 - Santa Maria - Rio Grande do Sul. Telefone: (51) 3226-4839</small>	
	<b>OBRA: CENTRO DE SAÚDE</b>	
<b>LOCAL: IF FARROUPILHA - CAMPUS SANTO ÂNGELO</b>		
<b>PROJETO: ESTRUTURAL</b>	<b>ÁREA:</b>	<b>24,07 m²</b>
<b>CONTEÚDO: MARQUISE METÁLICA</b>	<b>ESCALA:</b>	<b>Definida</b>
<b>PROPRIETÁRIO:</b>	<b>DATA:</b>	<b>Agosto/2018</b>
<small>INSTITUTO FEDERAL FARROUPILHA</small>	<b>DESENHO:</b>	<b>Luis Felipe</b>
	<b>PRANCHA:</b>	<b>01/01</b>